

BOROUGH OF ALLENDALE

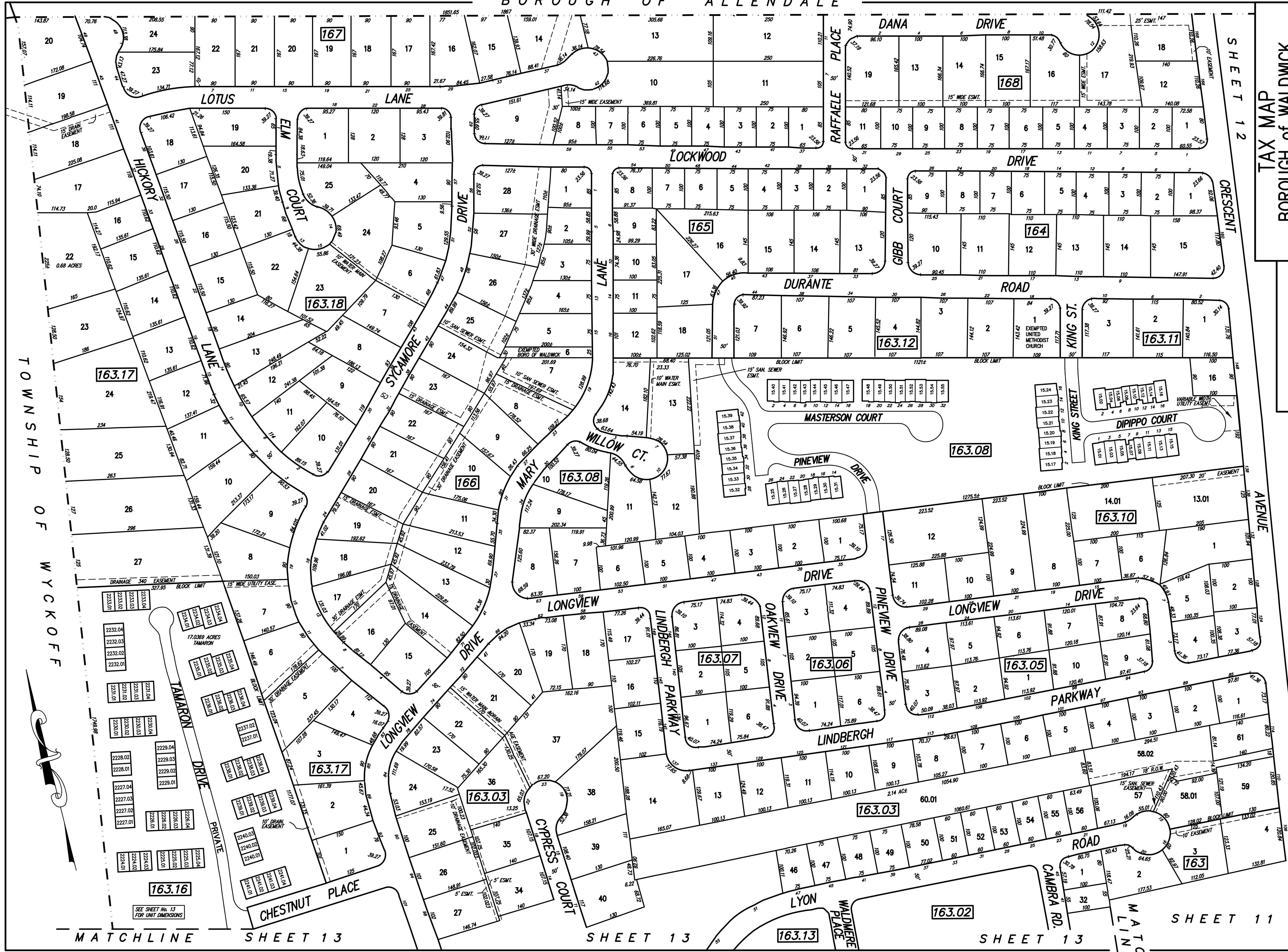

TAX MAP
 BOROUGH OF WALDWICK
 BERGEN COUNTY, NEW JERSEY
 SCALE: 1" = 100'
 DATE: JUNE 2002
KENNETH J. STIGNER, L.S.
 N.J. LIC. No. GS34493
Stantec Consulting Services, Inc.
 365 W. Passaic St., Rochelle Park, N.J. 07662

DATE	REVISIONS	NAME	LIC. No.
03/22/06		KENNETH J. STIGNER	GS34493
07/07/08		KENNETH J. STIGNER	GS34493
02/16/10		KENNETH J. STIGNER	GS34493
07/29/10		KENNETH J. STIGNER	GS34493
04/07/16		FRANK M. KRUPINSKI	GS37197

SHEET 12

SHEET 11

"This sheet has been redrawn using Computer Aided Drafting/Design (CAD/D) based on the map prepared by Boswell Engineering dated June 1997."

"This tax map supercedes the tax map approved on JUNE, 1997"